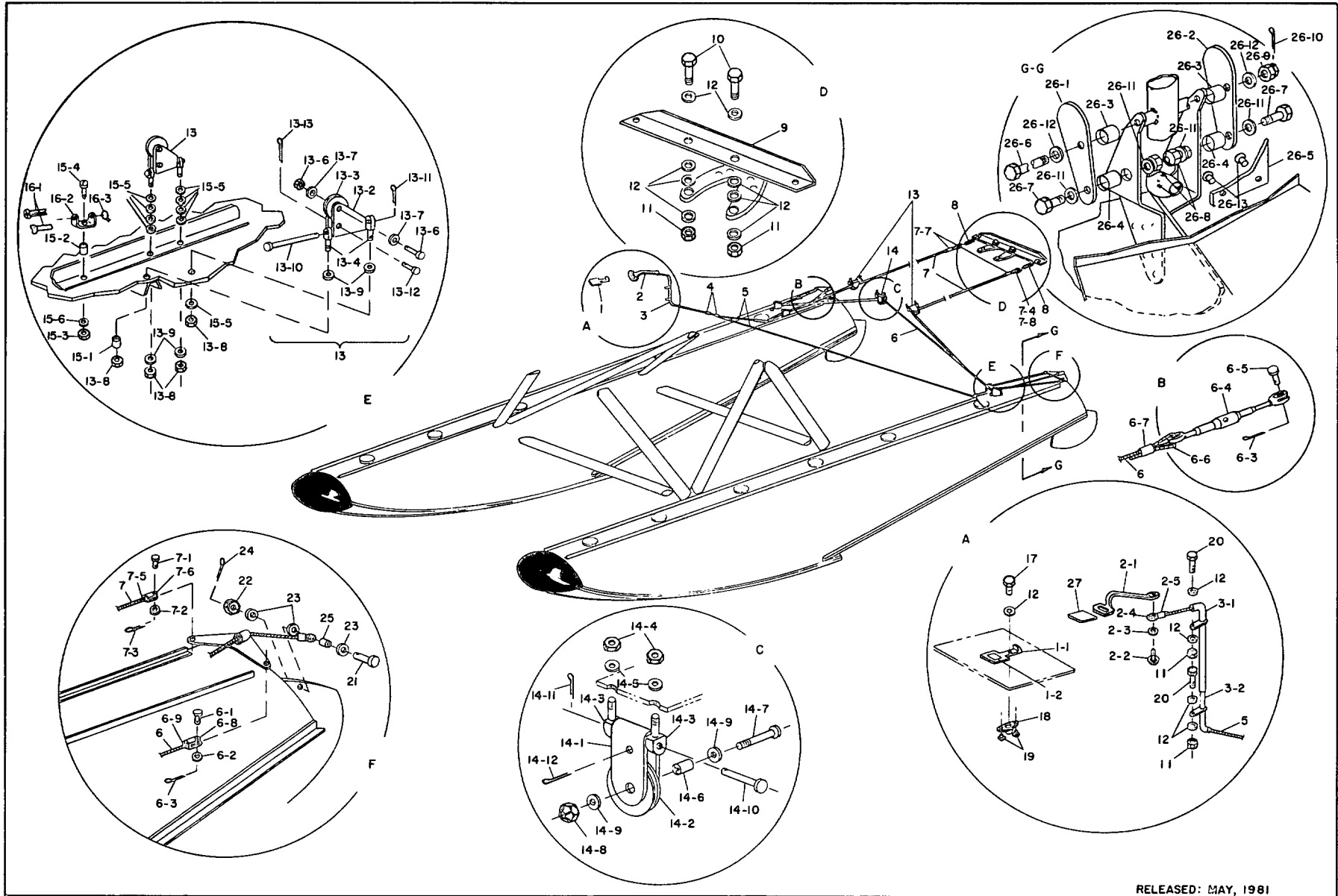

FIGURE 1. EDO ATTACHMENT GEAR MODEL 089-15 FOR EDO 089/089A2000 FLOATS ON CESSNA 172 (TUBULAR GEAR)

RELEASED: MAY, 1981

TABLE 1. EDO ATTACHMENT GEAR INSTALLATION MODEL 089-15 FOR CESSNA 172 (TUBULAR GEAR) ON 089/089A2000 FLOATS
KEY TO FIGURE 1.

REF NO.	QTY. PER			PART NUMBER	PART NAME	REF NO.	QTY. PER			PART NUMBER	PART NAME
	FLT.	ASY.	UNT.				FLT.	ASY.	UNT.		
1	1	2	-	69483	Strut-Fwd. L/R	33	1	2	-	AN26-26A	Bolt
2	1	2	-	69484-1	Strut-Diag. L/R	34	1	2	-	AN364-624	Nut
3	1	2	-	69485-3	Strut-Aft L/R	35	1	2	-	69479	Fitting - Aft Float
4	1	2	See	Tabulation Fig.1	Wirepull-Aft Fus. Attach	36	1	2	-	69478	Fitting - Fwd.Float
5	1	2	-	89-C-703	Spreader Assy. Fwd/Aft	37	2	4	-	AN960PD716	Washer
5-1	-	-	1	89-C-703-1	Tube - Spreader	38	1	2	-	AN365-720	Nut
5-2	-	-	2	89-C-704	Fitting - Spreader End	39	1	2	-	AN7-32A	Bolt
5-3	-	-	10	AN6DD24A	Bolt	40	-	1	-	089A1518-1	Faring - Tubular Gr.R.H.
5-4	-	-	22	AN960PD616	Washer	41	-	1	-	089A1518-2	Faring - Tubular Gr.L.H.
5-5	-	-	10	AN364D624	Nut	42	1	2	-	089A1519	Gasket
5-6	-	-	2	88-C-705	Plate - Spreader End	43	-	1	-	089A1541	Step Assy.
5-7	-	-	4	88-C-706	Eyebolt	43-1	-	-	1	5034-2	Step, R.H.
5-8	-	-	14	AN365-624	Nut	43-2	-	-	1	5034-1	Step, L.H.
5-9	-	-	4	AN6-21A	Bolt	43-3	-	-	4	AN4-17A	Bolt
5-10	-	-	4	88-C-710	Spacer	43-4	-	-	4	AN365-428A	Nut
5-11	-	-	2	AN6-24A	Bolt	43-5	-	-	8	AN960PD416	Washer
5-12	-	-	2	AN6-26A	Bolt	44	1	2	-	089-0800	Spray Rail Installation
5-13	-	-	2	88-C-708-3,8-42	Wirepull - Spreader	44-1	-	-	1	089-0801	Spray Rail
6	2	4	See	Tabulation Fig.1	Wirepull - Fwd. L/R	44-2	-	-	4	46065	Clip
7	1	2	-	1393-8700	Tierod Assy.-Spreader	44-3	-	-	20	MS20470AD5-6	Rivet
8	1	2	See	Tabulation Fig.1	Tierod Assy.-Fwd.	44-4	-	-	20	MS20470AD5-7	Rivet
9	1	2	See	Tabulation Fig.1	Tierod Assy.-Aft	45	-	1	-	40119	Spreader Faring Instl.
10	-	1	See	Tabulation Fig.1	Fitting-Fwd.Fus.-R.H.	45-1	-	-	4	40120	Faring Assy.
11	-	1	See	Tabulation Fig.1	Fitting-Fwd.Fus.-L.H.	45-2	-	-	4	40121	Faring Assy.
12	1	2	-	69482	Lug - Fwd. Strut	45-3	-	-	4	40122	Splice Plate Assy.
13	1	2	-	AN6-13A	Bolt	45-4	-	-	72	AN526-C-832R6	Screw
14	10	20	-	AN960PD616	Washer	45-5	-	-	56	C7000-832-C	Speed Nut
15	4	8	-	AN365-624	Nut						
16	2	4	-	AN4-6A	Bolt						
17	2	4	-	AN960PD416	Washer						
18	2	4	-	AN365-428	Nut						
19	6	12	-	AN25-26A	Bolt						
20	12	24	-	AN960PD516	Washer						
21	6	12	-	AN364-524	Nut						
22	2	4	-	AN3-6A	Bolt						
23	6	12	-	AN3-5A	Bolt						
24	8	16	-	AN960PD10	Washer						
25	8	16	-	AN365-1032	Nut						
26	-	1	-	089A1514-2	Fitting-Aft Fus. R.H.						
27	-	1	-	089A1514-1	Fitting-Aft Fus. L.H.						
28	1	2	-	089A1515	Fitting -Aft Fus.(Swl.)						
29	1	2	-	089A1516	Spacer Aft Fus. Attach						
30	1	2	-	88-C-710-1	Spacer - Wirepull						
31	1	2	-	AN6-31A	Bolt						
32	2	4	-	AN6-34A	Bolt						



RELEASED: MAY, 1981

FIGURE 2. EDO WATER RUDDER CONTROLS MODEL 089-15 FOR EDO 089/089A2000 FLOATS ON CESSNA 172 (TUBULAR GEAR)

TABLE 2. EDO WATER RUDDER CONTROLS INSTALLATION MODEL 089-15 FOR CESSNA 172 (TUBULAR GEAR) ON 089/089A2000 FLOATS
KEY TO FIGURE 2.

REF NO.	QTY. PER			PART NUMBER	PART NAME	REF NO.	QTY. PER			PART NUMBER	PART NAME
	FLT.	ASY.	UNT.				FLT.	ASY.	UNT.		
1	-	1	-	47954	Hook Assy.-Retract Handle	13-6	-	-	1	AN365-1032	Locknut
1-1	-	-	1	47955	Hook	13-7	-	-	2	AN960D10	Washer
1-2	-	-	1	36289	Placard	13-8	-	-	2	AN365-428	Locknut
2	-	1	-	47945	Forward Cable Assy.	13-9	-	-	2	AN960PD416	Washer
2-1	-	-	1	0367	Handle	13-10	-	-	1	AN394-73	Pin, Flathead
2-2	-	-	1	AN525-10-8	Screw	13-11	-	-	1	AN381-2-8	Cotter Pin
2-3	-	-	1	AN960PD10	Washer	13-12	-	-	1	AN393-15	Pin, Flathead
2-4	-	-	1	3355-120.0-3355	Cable	13-13	-	-	1	AN381-2-6	Cotter Pin
2-5	-	-	1	28-2-G	Nicopress Sleeve	14	-	1	-	2256	Pulley Bracket Assy.
3	-	1	-	2831	Fairlead Tube Assy.	14-1	-	-	1	2257	Bracket
3-1	-	-	1	2832	Tube Assy.-Upper	14-2	-	-	1	0915-1	Pulley
3-2	-	-	1	2833	Tube Assy.-Lower	14-3	-	-	2	00-W-850	Eyebolt
4	-	2	-	28-2-G	Nicopress Sleeve	14-4	-	-	2	AN365-428	Locknut
5	1	2	-	3340-216.0-3355	Cable Assy.W/R Retract	14-5	-	-	2	AN960PD416	Washer
5-1	-	-	1	28-2-G	Nicopress Sleeve	14-6	-	-	1	0210	Bushing
6	-	1	-	3343-192.0-3353	Cable Assy. Interfloat	14-7	-	-	1	AN3-7A	Bolt
6-1	-	-	1	AN393-9	Pin, Flathead	14-8	-	-	1	AN365-1032	Locknut
6-2	-	-	1	AN960-10L	Washer	14-9	-	-	2	AN960D10	Washer
6-3	-	-	2	AN381-2-6	Cotter Pin	14-10	-	-	1	AN394-41	Pin, Flathead
6-4	-	-	1	AN130-16S	Turnbuckle	14-11	-	-	1	AN381-2-8	Cotter Pin
6-5	-	-	1	AN393-11	Pin, Flathead	14-12	-	-	1	AN381-3-12	Cotter Pin
6-6	-	-	1	AN100C4	Thimble,Wire Cable	15	1	2	-	89-WS-505	Instl. Deck Hardware
6-7	-	-	1	28-2-G	Nicopress Sleeve	See Item 13	-	-	2	60-W-911	Pulley Bracket Assy.
6-8	-	-	1	RA2500-3	Terminal	15-1	-	-	1	92-WS-506-1	Spacer
6-9	-	-	1	AN664C3	Terminal, Ball End	15-2	-	-	1	2712	Spacer
7	1	2	-	3343-192.0-3351	Cable Assy. W/R Control	15-3	-	-	1	AN365-1032	Nut
7-1	-	-	1	AN393-9	Pin, Flathead	15-4	-	-	1	AN526-1032-18	Screw
7-2	-	-	1	AN960-10L	Washer	15-5	-	-	9	AN960PD416	Washer
7-3	-	-	1	AN381-2-6	Cotter Pin	15-6	-	-	1	AN960PD10	Washer
7-4	-	-	1	AN140-16S	Turnbuckle	16 *	1	2	-	68-W-654	Fairlead Assy.
7-5	-	-	1	AN664C3	Terminal, Ball End	16-1	-	-	2	0494	Fairlead
7-6	-	-	1	RA2500-3	Terminal	16-2	-	-	1	68-W-654-1	Bracket
7-7	-	-	1	28-2-G	Nicopress Sleeve	16-3	-	-	A/R	AN955C41-2	Lockwire
7-8	-	-	1	AN100C4	Thimble, Wire Cable	17	-	1	-	AN525-832-12	Screw
8	-	2	-	D-376	Spring	18	-	1	-	AN362-F-832	Nut Plate
9	-	1	-	32682	Extension, Rudder Horn	19	-	2	-	AN470AD3-4	Rivet
10	-	2	-	AN3-7A	Bolt	20	-	2	-	AN526-1032-8	Screw
11	-	2	-	AN365-1032	Locknut	21	-	1	-	AN4-7	Bolt
12	-	12	-	AN960PD10	Washer	22	-	1	-	AN310-4	Nut
13	3	6	-	60-W-911	Pulley Bracket Assy.	23	-	3	-	AN960PD416	Washer
13-1	-	-	1	60-W-911-1	Pulley Bkt. Sub-Assy.	24	-	1	-	AN381-2-12	Cotter Pin
13-2	-	-	1	0209	Bracket	25	-	1	-	88-W-070-1	Spacer
13-3	-	-	1	0915	Pulley	26	-	1	-	2891	Instl.Assy.W/R Ctr.Lock
13-4	-	-	2	00-W-850	Eyebolt	26-1	-	-	1	2893	Cam, R.H.
13-5	-	-	1	AN3-7A	Bolt	26-2	-	-	1	2892	Cam, L.H.

TABLE 2. EDO WATER RUDDER CONTROLS INSTALLATION MODEL 089-15 FOR CESSNA 172 (TUBULAR GEAR) ON 089/089A2000 FLOATS
KEY TO FIGURE 2.

REF NO.	QTY. PER			PART NUMBER	PART NAME	REF NO.	QTY. PER			PART NUMBER	PART NAME
	FLT.	ASY.	UNT.				FLT.	ASY.	UNT.		
26-3	-	-	2	2894	Spacer						
26-4	-	-	2	2895	Spacer						
26-5	-	-	2	2896	Rubbing Strip						
26-6	-	-	1	AN5-51	Bolt						
26-7	-	-	2	AN3-16A	Bolt						
26-8	-	-	2	AN365-1032	Locknut						
26-9	-	-	1	AN310-5	Nut						
26-10	-	-	1	AN381-2-12	Cotter Pin						
26-11	-	-	4	AN960PD10	Washer						
26-12	-	-	2	AN960PD516	Washer						
26-13	-	-	8	AN456AD5-7	Rivet						
27	-	1	-	5031	Placard						
<p>* Item 16 is included with (part of) item 15, Instl. Deck Hdwe. It is shown here separately for individual ordering purposes only.</p>											