

TABLE 1. EDO ATTACHMENT GEAR INSTALLATION MODEL 089-26 FOR PIPER PA-18 (EXTRUDED STRUTS) ON 089/089A2000 FLOATS  
KEY TO FIGURE 1.

REF NO.	QTY. PER			PART NUMBER	PART NAME	REF NO.	QTY. PER			PART NUMBER	PART NAME
	FLT.	ASY.	UNT.				FLT.	ASY.	UNT.		
1	1	2	-	69475	Strut - Fwd. L/R	22	2	4	-	AN365-1032	Nut
2	1	2	-	69476	Strut - Diag. L/R	23	2	4	-	14408	Angle Bolt
3	1	2	-	69477	Strut - Aft L/R	24	2	4	-	05990	Saddle Plate
4	1	2	-	89-C-703	Spreader Assy. Fwd/Aft	25	4	8	-	AN365-428	Nut
4-1	-	-	1	89-C-703-1	Tube - Spreader	26	4	8	-	AN960PD416	Washer
4-2	-	-	2	89-C-704	Fitting-Spreader End	27	1	2	-	69472	Fitting-Fwd. Float
4-3	-	-	10	AN6DD24A	Bolt	28	1	2	-	AN6-33A	Bolt
4-4	-	-	22	AN960PD616	Washer	29	-	1	-	69473-2	Fitting-Aft Float, R.H.
4-5	-	-	10	AN364D624	Nut	30	-	1	-	69473-1	Fitting-Aft Float, L.H.
4-6	-	-	2	88-C-705	Plate-Spreader End	31	1	2	-	14393	Wirepull - Front Fus.
4-7	-	-	4	88-C-706	Eyebolt	32	1	2	-	AN960-516	Washer(For Mod.150 Only)
4-8	-	-	14	AN365-624	Nut	33	1	2	-	AN5-25A	Bolt (For Mod.150 Only)
4-9	-	-	4	AN6-21A	Bolt	34	1	2	-	41046	Step Assy.
4-10	-	-	4	88-C-710	Spacer	34-1	-	-	1	41046-1	Brace
4-11	-	-	2	AN6-24A	Bolt	34-2	-	-	1	41046-2	Tube
4-12	-	-	2	AN6-26A	Bolt	34-3	-	-	1	41083	Cap
4-13	-	-	2	88-C-708-3.8-42	Wirepull - Spreader	34-4	-	-	1	AN535-10-6	Drive Screw
5	1	2	-	88-C-709-3.5-27	Wirepull-Fwd. L/R	35	2	4	-	AN24-27A	Bolt
6	1	2	-	88-C-709-1.2-29	Wirepull-Aft L/R	36	4	8	-	AN960-416	Washer
7	1	2	-	3393-8700	Tierod Assy.-Spreader	37	2	4	-	AN364-428	Nut
8	1	2	-	3394-4800	Tierod Assy.-Fwd.	38	1	2	-	AN365-524	Nut (For Mod. 150 Only)
9	1	2	-	3394-4625	Tierod Assy.-Aft	39	1	2	-	AN4-25A	Bolt
10	-	1	-	69471-2	Fitting-Fwd.Fus. R.H.	40	1	2	-	AN960PD416	Washer
11	-	1	-	69471-1	Fitting-Fwd.Fus. L.H.	41	1	2	-	14413-1	Bushing
12	2	4	-	AN6-34A	Bolt	42	1	2	-	14412	Bushing
13	3	6	-	AN365-624	Nut	43	-	1	-	40119	Spreader Faring Instl.
14	9	18	-	AN960PD616	Washer	43-1	-	-	4	40120	Faring Assy.
15	2	4	-	AN26-26A	Bolt	43-2	-	-	4	40121	Faring Assy.
16	2	4	-	AN364-624	Nut	43-3	-	-	4	40122	Splice Plate Assy.
17	4	8	-	AN25-26A	Bolt	43-4	-	-	72	AN526-C-832R6	Screw
18	4	8	-	AN364-524	Nut	43-5	-	-	56	C7000-832-C	Speed Nut
19	9	18	-	AN960PD516	Washer						
20	1	2	-	69474	Fitting-Aft Fus. L/R						
20-1	-	-	2	69474-1	Shim						
20-2	-	-	1	14404	Inner Plate						
20-3	-	-	1	14405	Upper Plate						
20-4	-	-	1	14406	Lower Plate						
20-5	-	-	1	14407	Spacer						
20-6	-	-	3	AN426AD5	Rivet						
20-7	-	-	8	AN960PD10	Washer						
20-8	-	-	4	AN365-1032	Nut						
20-9	-	-	2	AN3-6A	Bolt						
20-10	-	-	2	AN3-11A	Bolt						
21	1	2	-	14409	'U' Bolt						
21A	2	4	-	AN960PD10	Washer						

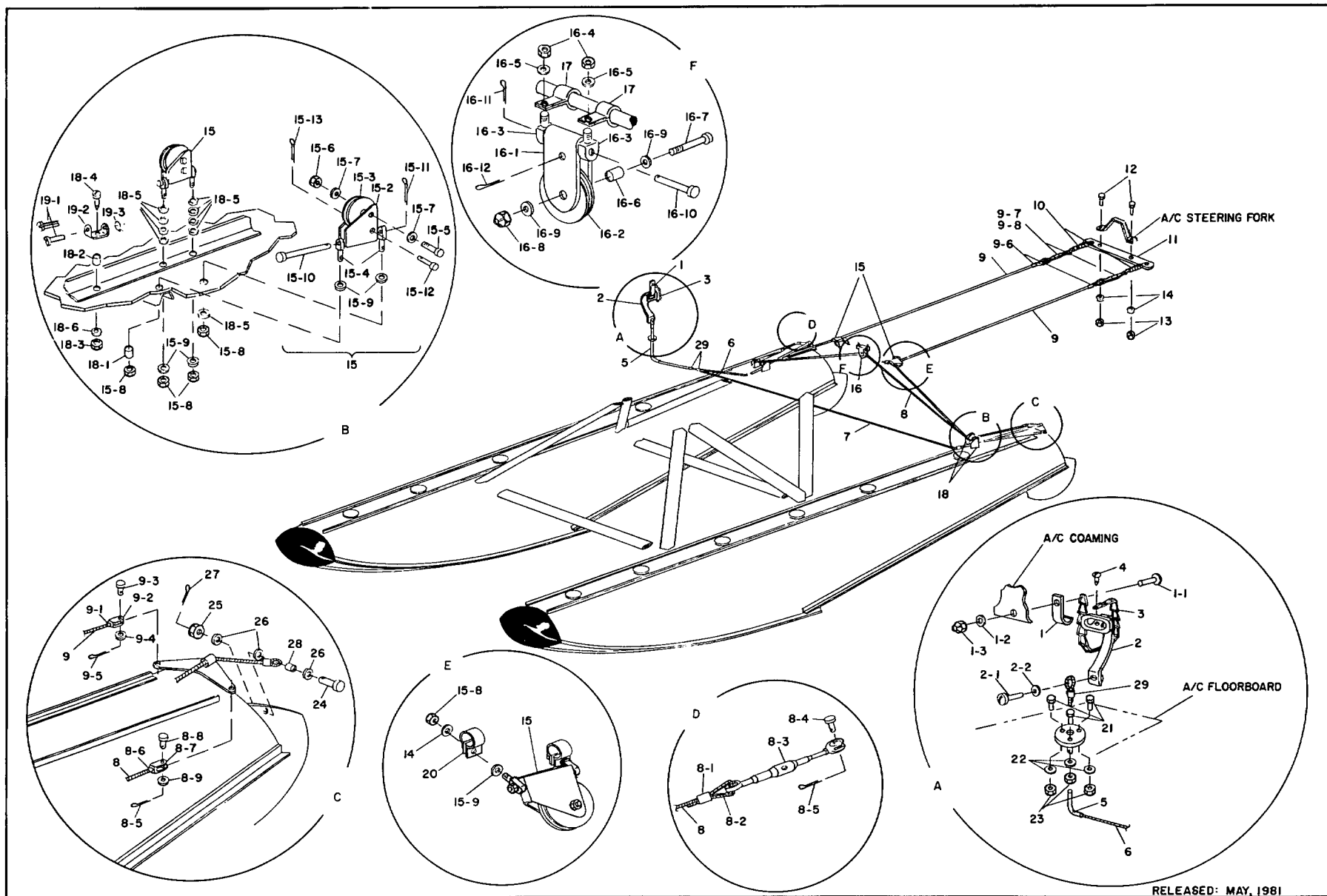

FIGURE 2. EDO WATER RUDDER CONTROLS MODEL O89-26 FOR EDO O89/O89A2000 FLOATS ON PIPER PA-18 (EXTRUDED GEAR)

TABLE 2. EDO WATER RUDDER CONTROLS INSTALLATION MODEL 089-26 FOR PIPER PA-18 (EXTRUDED STRUTS) ON 089/089A2000 FLOATS  
KEY TO FIGURE 2.

REF NO.	QTY. PER			PART NUMBER	PART NAME	REF NO.	QTY. PER			PART NUMBER	PART NAME
	FLT.	ASY.	UNT.				FLT.	ASY.	UNT.		
1	-	1	-	60-W-043	Hook	15-7	-	-	2	AN960D10	Washer
1-1	-	-	1	AN526-1032-12	Screw	15-8	-	-	2	AN365-428	Locknut
1-2	-	-	1	AN960D10	Washer	15-9	-	-	2	AN960PD416	Washer
1-3	-	-	1	AN365-1032	Locknut	15-10	-	-	1	AN394-73	Pin, Flathead
2	-	1	-	0367-1	Handle	15-11	-	-	1	AN381-2-8	Cotter Pin
2-1	-	-	1	AN525-10-8	Screw	15-12	-	-	1	AN393-15	Pin, Flathead
2-2	-	-	1	AN960D10	Washer	15-13	-	-	1	AN381-2-6	Cotter Pin
3	-	A/R	-	#8 Galv.	Chain (12" Lg.)	16	-	1	-	2256	Pulley Bracket Assy.
4	-	1	-	AN504-6-8	Screw	16-1	-	-	1	2257	Bracket
5	-	1	-	92-WS-509	Fairlead Assy.	16-2	-	-	1	0915-1	Pulley
6	-	1	-	3340-175.0-3355	Cable Assy.-Fwd. Retract	16-3	-	-	2	00-W-850	Eyebolt
6-1	-	-	1	28-2-G	Nicopress Sleeve	16-4	-	-	2	AN365-428	Locknut
7	-	1	-	3340-134.0-3355	Cable Assy.-Aft Retract	16-5	-	-	2	AN960PD416	Washer
7-1	-	-	1	28-2-G	Nicopress Sleeve	16-6	-	-	1	0210	Bushing
8	-	1	-	3343-192.0-3353	Cable Assy.-Interfloat	16-7	-	-	1	AN3-7A	Bolt
8-1	-	-	1	28-2-G	Nicopress Sleeve	16-8	-	-	1	AN365-1032	Locknut
8-2	-	-	1	AN100C4	Thimble, Wire Cable	16-9	-	-	2	AN960D10	Washer
8-3	-	-	1	AN130-16S	Turnbuckle	16-10	-	-	1	AN394-41	Pin, Flathead
8-4	-	-	1	AN393-11	Pin, Flathead	16-11	-	-	1	AN381-2-8	Cotter Pin
8-5	-	-	2	AN381-2-6	Cotter Pin	16-12	-	-	1	AN381-3-12	Cotter Pin
8-6	-	-	1	AN664C3	Terminal, Ball End	17	1	2	-	2258-4	Clamp, Tube
8-7	-	-	1	RA2500-3	Terminal	18	1	2	-	89-WS-505	Instl., Deck Hardware
8-8	-	-	1	AN393-9	Pin, Flathead	See Item 15	-	-	2	60-W-911	Pulley Bracket Assy.
8-9	-	-	1	AN960-10L	Washer	18-1	-	-	1	92-WS-506-1	Spacer
9	1	2	-	3343-224.0-3351	Cable Assy.-W/R Control	18-2	-	-	1	2712	Spacer
9-1	-	-	1	AN664C3	Terminal, Ball End	18-3	-	-	1	AN365-1032	Locknut
9-2	-	-	1	RA2500-3	Terminal	18-4	-	-	1	AN526-1032-18	Screw
9-3	-	-	1	AN393-9	Pin, Flathead	18-5	-	-	9	AN960PD416	Washer
9-4	-	-	1	AN960-10L	Washer	18-6	-	-	1	AN960PD10	Washer
9-5	-	-	1	AN381-2-6	Cotter Pin	19*	1	2	-	68-W-654	Fairlead Assy.
9-6	-	-	1	28-2-G	Nicopress Sleeve	19-1	-	-	2	0494	Fairlead
9-7	-	-	1	AN100C4	Thimble, Wire Cable	19-2	-	-	1	68-W-654-1	Bracket
9-8	-	-	1	AN140-16S	Turnbuckle	19-3	-	-	A/R	AN955C41-2	Lockwire
10	1	2	-	D-376	Spring	20	2	4	-	89-WS-501-2	Clamp, Tube
11	-	1	-	92-WS-508	Arm, W/R Control	21	-	3	-	AN526-832-12	Screw
12	1	2	-	AN4-6A	Bolt	22	-	3	-	AN960-8	Washer
13	1	2	-	AN365-428	Locknut	23	-	3	-	AN365-832	Locknut
14	3	6	-	AN960D416	Washer	24	1	2	-	AN4-7	Bolt
15	1	2	-	60-W-911	Pulley Bracket Assy.	25	1	2	-	AN310-4	Nut
15-1	-	-	1	60-W-911-1	Pulley Bkt. Sub-Assy.	26	3	6	-	AN960PD416	Washer
15-2	-	-	1	0209	Bracket	27	1	2	-	AN381-2-12	Cotter Pin
15-3	-	-	1	0915	Pulley	28	1	2	-	88-W-070-1	Spacer
15-4	-	-	2	00-W-850	Eyebolt	29	-	3	-	28-2-G	Nicopress Sleeve
15-5	-	-	1	AN3-7A	Bolt						
15-6	-	-	1	AN365-1032	Locknut						

\* Item 19 is included with (part of) item 18, Instl. Deck Hdw. It is shown here separately for individual ordering purposes only.

11A-5