

FIGURE 1. EDO MODEL 289-2700 FLOAT

TABLE 1. EDO MODEL 289-2700 FLOAT SPARE PARTS LIST
KEY TO FIGURE 1

Revised 10/1/68

REF. NO.	PART NUMBER	PART NAME	REF. NO.	PART NUMBER	PART NAME
1	22812	Bulkhead Assy.-Sta. 3	31	NAS 147-113	Bolt (4 Req.)
2	22781	Bulkhead Assy.-Sta. 4	32	AN515-516R44	Screw (2 Req.)
3	22814	Bulkhead Assy.-Sta. 5	33	AN935-516	Lockwasher (2 Req.)
4	16420	Bulkhead Assy.-Sta. 7	34	AN960D516	Washer (2 Req.)
5	16425	Bulkhead Assy.-Sta. 8	35	AN960-716	Washer
6	16430	Transom Assy.-Sta. 9	36	AN960D716	Washer (12 Req.)
7	23101	Bow Well Assembly	37	AN365-720	Nut (5 Req.)
8	20200	Main Well Assembly	38	16498	Deck Block Inner (2 Req.)
9	20184	Keelson Forward	39	16495	Spreader Block Upper (2 Req.)
10	20185	Sister Keelson Fwd. LH	40	16496	Spreader Block Lower (2 Req.)
11	20186	Sister Keelson Fwd. RH	41	AN960D616	Washer (14 Req.)
12	20187	Keelson Aft	42	AN365-624	Nut (8 Req.)
13	20360	Deck Sub-Assy.-Sta. 1 to 3	43	AN960D516	Washer (32 Req.)
14	20370	Tunnel Assy.-Fwd. Deck	44	AN365-524	Nut (16 Req.)
15	20233	Deck Beam Fwd.	45	AN5-10A	Bolt (16 Req.)
16	23201	Tunnel Assy.-Aft Deck	46	AN7-37A	Bolt (4 Req.)
17	16467	Deck Beam Aft	47	AN6-21A	Bolt (2 Req.)
18	20372	Deck Rail Fwd. (2 Req.)	48	AN960-616	Washer (2 Req.)
19	23202	Deck Rail Aft (2 Req.)	49	AN526-1032R9	Screw (20 Req.)
20	16504	Strap-External Splice (2 Req.)	50	AN960D10	Washer (20 Req.)
21	16505	Strap-Internal Splice (2 Req.)	51	AN6-11A	Bolt (6 Req.)
22	16449	Deck Strap (2 Req.)	52	16560	Clamp-Outer Spreader (4 Req.)
23	16497	Deck Block Outer (2 Req.)	53	16565	Tapped Strip (4 Req.)
24	1547-23	Wirepull Front	54	16563	Clamp-Inner Spreader (4 Req.)
	1547-27	Wirepull Rear	55	16549	Wirepull-Spreader (2 Req.)
25	1408-50	Front Channel Fitting	56	20182	Bottom Skin Fwd. RH
26	1407-46	Rear Channel Fitting	57	20181	Bottom Skin Fwd. LH
27	1409-25	Int. Channel Fitting	58	20183	Bottom Skin Aft
28	16548	Bushing (4 Req.)	59	20188	Keel-Rubbing Strip
29	S-1452-070	Barrel Nut (Esna) (3 Req.)	60	16750	Clamp RH
30	16547	Spacer	61	16749	Clamp LH

TABLE 1. EDO MODEL 289-2700 FLOAT SPARE PARTS LIST
KEY TO FIGURE 1 (CON'T)

REF. NO.	PART NUMBER	PART NAME	REF. NO.	PART NUMBER	PART NAME
62	23204	Cleat	75	16580	Blade Assembly
63	AN509-416R13	Screw (4 Req.)	76	16354	Deck Bracket
64	AN365-428	Nut (4 Req.)	77	38-075	Bracket-Transom
65	29071	Bottom Skin-Intermediate	78	AN396-71	Pin
66	20373	Chine Fwd. LH	79	AN960-616	Washer
	20374	Chine Fwd. RH	80	AN381-3-12	Cotter Pin (2 Req.)
67	16348	Chine Aft RH and LH	81	AN396-45	Pin
68	16768	Angle-Chine Splice LH	82	38-093	Spring (2 Req.)
	16769	Angle-Chine Splice RH	83	AN381-2-6	Cotter Pin (2 Req.)
69	16589	Pulley Brace Assembly	84	AN393-13	Pin (2 Req.)
70	AN525-416R24	Screw (2 Req.)	85	AN7-34	Bolt
71	AN960D416	Washer (10 Req.)	86	AN960D716	Washer (2 Req.)
72	AN365-428	Nut (2 Req.)	87	AN320-7	Nut
73	16305	Water Rudder Installation L/H	88	AN381-3-14	Cotter Pin
	16306	Water Rudder Installation R/H	89	1575	Cover Assembly (10 Req.)
74	16570	Post Assembly L/H			
	16571	Post Assembly R/H			

Revised 10/1/68

Revised 10/1/68
JK

TABLE 1. EDO MODEL 289-2700 FLOAT SPARE PARTS LIST
 KEY TO FIGURE 1. (CON'T)

REF. NO.	PART NUMBER	PART NAME	REF. NO.	PART NUMBER	PART NAME
90	1582	Gasket (10 Req.)	104	20148 (Ref.)	Main Gear Assembly L/H (See Figure 2, Page 6)
91	23193	Cover		20149 (Ref.)	Main Gear Assembly R/H (See Figure 2, Page 6)
92	AN526-832R8	Screw			
93	AN960PD8	Washer	105	20210	Bulkhead Assembly-Sta.5A
94	23194	Cover	106	20220	Frame Assembly-Sta. S
95	20397	Cover	107	20265	Bulkhead Assembly-Sta. 6
96	22662	Cover	108	16481 (Qty.3)	Rubber Water Stop Kit
97	AN526-832R10	Screw		16482 (Qty.3)	for Bulkhead Stations
98	22661	Gasket		16483 (Qty.1)	3, 4, 5 or 5A as Required
99	20351	Bow Cap Assembly		16484 (Qty.2)	
100	AN4-15A	Bolt	109	20291 (Qty.2)	Rubber Water Stop Kit
101	20341	Bumper-Pivot Arm		20292 (Qty.2)	for Bulkhead Sta. 6
102	20377	Bow Plate	110	16481 (Qty.1)	Rubber Water Stop Kit
103	27380 (Ref.)	Bow Gear Assembly (See Figure 2, Page 6)		16482 (Qty.1)	for Bulkhead Stations
				16483 (Qty.1)	7 and 8

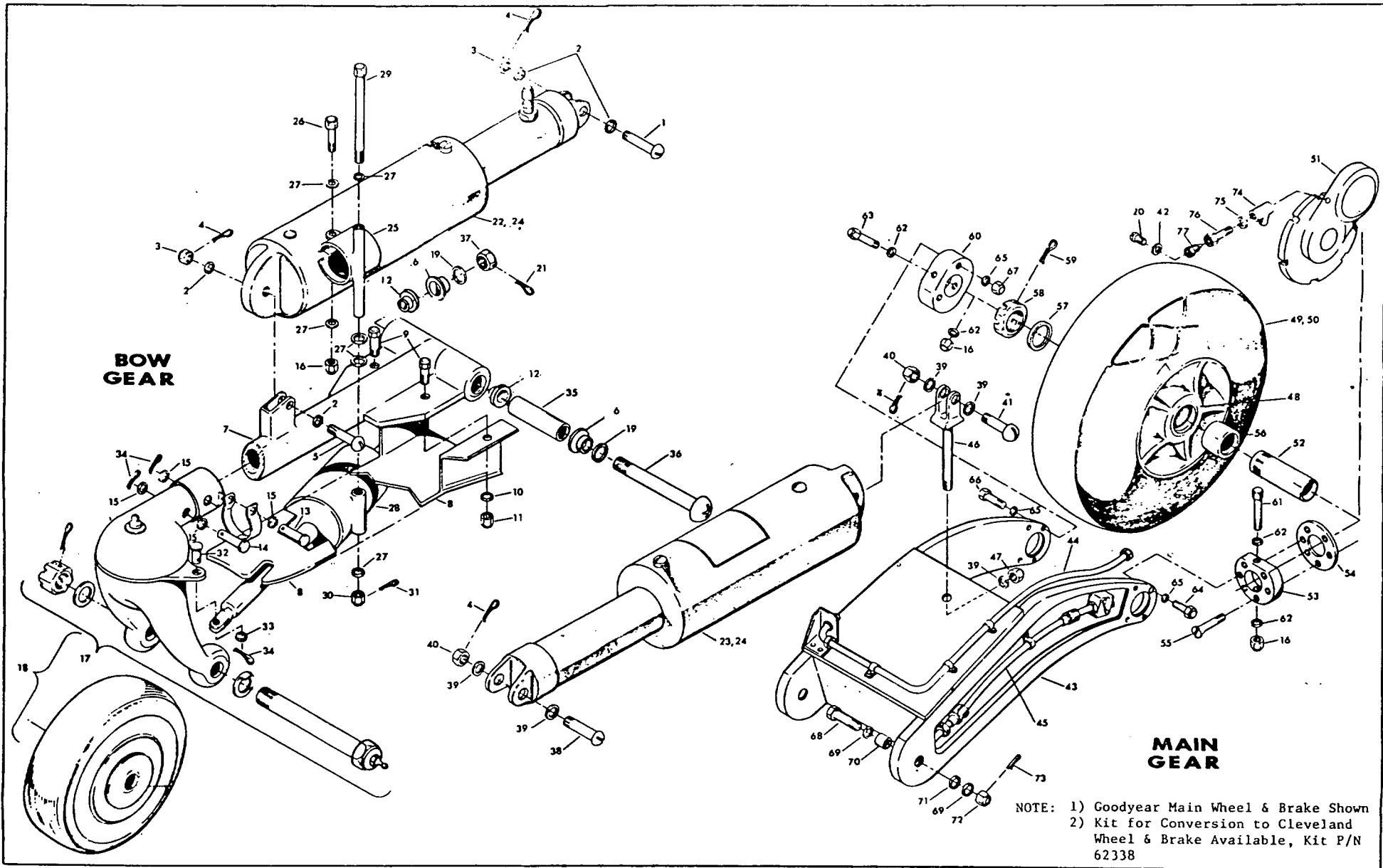

FIGURE 2. EDO BOW AND MAIN LANDING GEAR

Revised 10/1/58

Revised 10/1/68

TABLE 2. EDO BOW AND MAIN LANDING GEAR
KEY TO FIGURE 2

REF. NO.	PART NUMBER	PART NAME	REF. NO.	PART NUMBER	PART NAME	REF. NO.	PART NUMBER	PART NAME
1	AN26-27	Bolt	26	AN4-7A	Bolt	51	9531446PD353-4	Brake Assembly
2	AN960D616	Washer	27	AN960-416	Washer		9530287	Disc-Brake
3	AN320-6	Nut	28	31333	Shimmy Damper Assy.		9511269	Brake Lining
4	AN381-3-12	Cotter Pin	29	AN4-33	Bolt		9511271	Brake Lining
5	AN26-17	Bolt	30	AN310-4	Nut	52	20172	Axle
6	23152	Bushing	31	AN381-2-12	Cotter Pin	53	20174	Bearing Block
7	20345	Pivot Arm	32	AN394-15	Flat Head Pin	54	20175	Tapped Ring
8	27387	Cover Assembly	33	AN960-416L	Washer	55	AN509-516R25	Screw
9	AN3-4A	Bolt	34	AN381-2-8	Cotter Pin	56	20177	Spacer-Long
10	AN960D10	Washer	35	NAS73-8-212	Bushing	57	20176	Spacer-Short
11	AN365-1032	Nut	36	AN28-60	Bolt	58	AN7502-24	Nut
12	NAS77-11-50	Bushing	37	AN320-8	Nut	59	AN381-4-32	Cotter Pin
13	AN394-65	Flat Head Pin	38	AN27-27	Bolt	60	20173	Bearing Block
14	AN394-57	Flat Head Pin	39	AN960D716	Washer	61	AN4-31A	Bolt
15	AN960D416	Washer	40	AN320-7	Nut	62	AN960D416L	Washer
16	AN365-428	Nut	41	AN27-25	Bolt	63	AN4-24A	Bolt
17	3400D-3	10" Fork & Bracket Assy. (Fig. 2a)	42	AN935-10	Washer	64	AN5H24A	Bolt
18	3400D	10" Bow Wheel Assy. (Fig. 2a)	43	20150	Yoke Assembly	65	AN960D516L	Washer
19	AN960D816	Washer	44	1648-272	Tube Assy-Hydraulic	66	AN5-21A	Bolt
20	AN520-10-6	Screw	45	1648-153	Tube Assy-Lubricating	67	AN365-524	Nut
21	AN381-3-18	Cotter Pin	46	20166	Eyebolt	68	AN5-24	Bolt
22	54715*	Shock Strut-Bow (See Ref. #24)	47	AN365-720	Nut	69	AN960D516	Washer
23	51961**	Shock Strut-Main (See Ref. #24)	48	9531445PD353-4	Wheel Assembly	70	NAS73-5-105	Bushing
24	62907	Seal Kit		13836 SRL	Bearing Cup	71	203AC-5/16	Lock-O-Seal
25	28904	Clamp Assembly	49	13889 SPL	Bearing Cone	72	AN310-5	Nut
				51 x 907	Seal (Alt. 63 x 907)	73	AN381-2-14	Cotter Pin
				6.00-6	Tire-Six Ply Nylon type III	74	AN778-4D	Elbow
				6.00-6	Tube	75	AN901-4A	Gasket
						76	22909	Bolt
						77	AN6204-1	Valve

*PART NUMBER 54715 REPLACES NUMBER 400-102-2

**PART NUMBER 51961 REPLACES NUMBER 400-102-1

~~13836~~ Goodyear

20241 Bow Seal Kit

Date 10/1/68

REF. NO.	PART NUMBER	PART NAME	NO. REQUIRED	
			3400D	3400D-3
1	800859	Bracket Assy.	1	1
2	08118	Cone Bearing (Timken)	1	1
3	3407	Spacer	1	1
4	3411D	Dust Cap Set	1	1
5	3408	Washer	1	1
6	3408-1	Washer	A/R	A/R
7	3219-2	Pawl	1	1
8	3416-1	Arm and Cage Assy.	1	1
9	3408-2	Washer	1 or 2	1 or 2
10	3423	Fork Assy.	1	1
11	AN380-3-3	Cotter Pin	2	2
12	AN960-816	Washer	2	2
13	2504-1	Spacer	1	1
14	1863	Retainer - Grease	1	1
15	A4050	Cone Bearing (Timken)	1	1
16	3257	Pin	1	1
17	3258-3	Spacer	A/R	A/R
18	3258	Spacer	1	1
19	3222	Spring	1	1
20	3258-1	Spacer	A/R	A/R
21	AN310-8	Nut-Castle	2	2
22	3236C-2	Axle Assy.	1	1
23	3225	Washer-Lock	1	1
24	3245	10" Tire & Wheel Assy.	1	-
25	3244-1	Wheel Assembly	1	-
26	10x3.50-4	Tire - 4 Ply	1	-
27	10x3.50-4	Tube	1	-

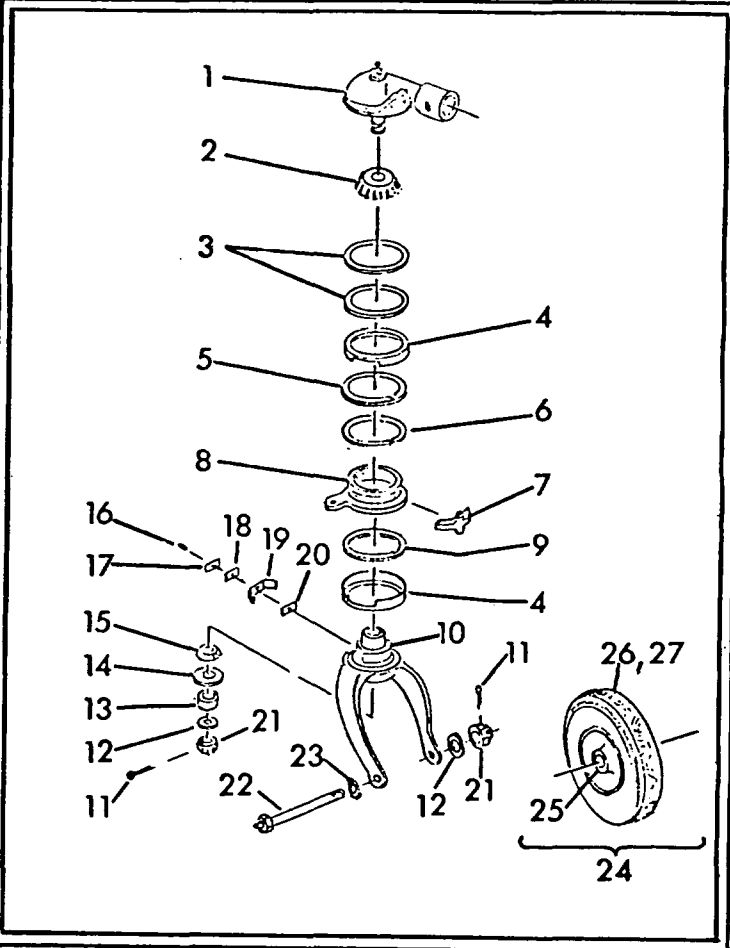

FIGURE 2a. EDO 3400D SERIES BOW WHEEL

Revised 10/1/68

JK

TABLE 3. EDO LANDING GEAR SYSTEM MODEL 289
KEY TO FIGURE 3

REF. NO.	PART NUMBER	PART NAME	REF. NO.	PART NUMBER	PART NAME
1	23151	Fitting Assy.-Bow Slide	7	AN4-7A	Bolt (4 Req.)
2	20367	Tube Assy.-Bow Slide	8	AN960D416	Washer (10 Req.)
3	AN219-4	Pulley (6 Req.)	9	AN960D416L	Washer (2 Req.)
4	20450 ✓	Cable Assy.-Bow	10	AN365-428	Nut (4 Req.)
5	20449 ✓	Cable Assy.-Bow	11	20448 ✓	Cable Assy.-Main
6	A-426	Actuator Assy. (1)	12	20447 ✓	Cable Assy.-Main
	L-426	Actuator (1)	13	20154	Tube-Main Slide
	2200	Electric Motor (1)	14	23150	Fitting Assy.-Main Slide
	22104	Brush (1)(2 Req.)	15	NAS77-6-23	Bushing
	22103	Brush Holders (1)(2 Req.)	16	NAS77-7-23	Bushing
	20149	Brush Caps (1)(2 Req.)			

NOTES: (1) Lundy Mfg. Corp.